

INNOLIFT

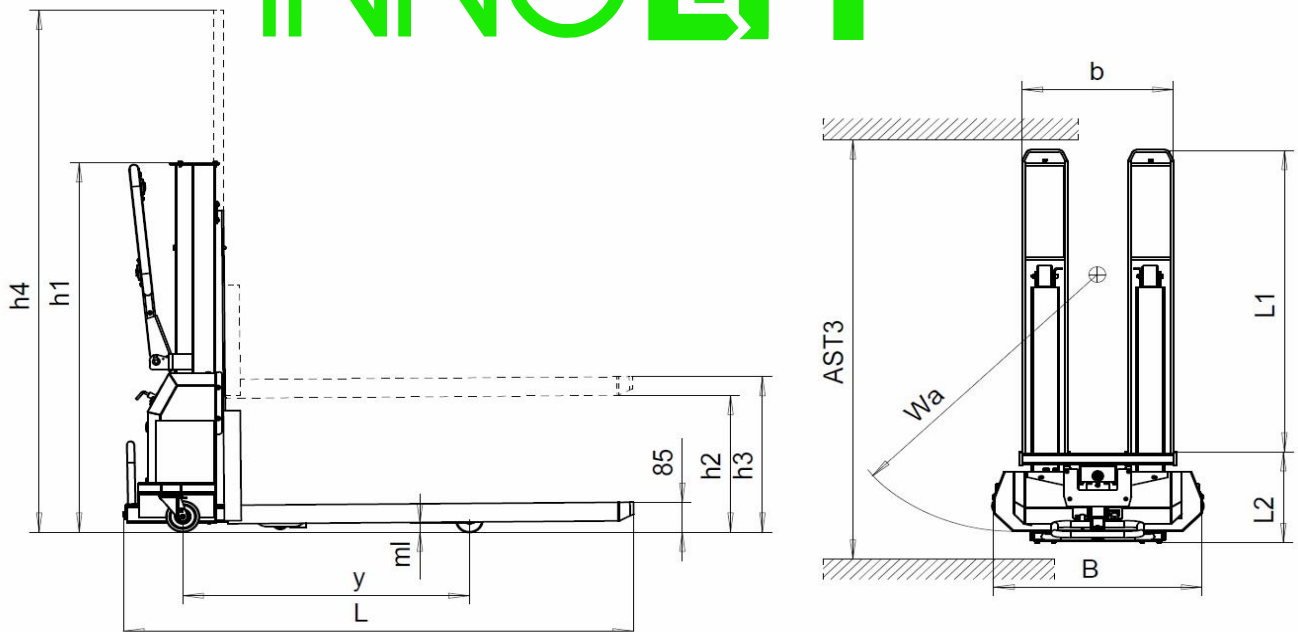

**Technical Data Sheet
INNOLIFT**

Standard Models

		IS600.700	IM600.800	IL600.1000	IXL500.1250	IXXL400.1400
Power		Battery	Battery	Battery	Battery	Battery
Capacity	kg	600	600	600	500	400
Load centre	mm	600	600	600	600	600
Lifting height	mm h3	700	800	1000	1250	1400
Loading height	mm h2	600	700	900	1150	1300
Own weight	kg	175	179	184	189	198
Overall lowered height	mm h1	1100	1200	1400	1650	1800
Overall extended height	mm h4	1690	1890	2290	2790	3090
Wheel material		Polyurthan	Polyurthan	Polyurthan	Polyurthan	Polyurethan
Wheel dimensions, front	mm	75 x 60	75 x 60	75 x 60	75 x 60	75 x 60
Wheel dimensions, rear	mm	100 x 40	100 x 40	100 x 40	100 x 40	100 x 40
Total length	mm L	1520	1520	1520	1520	1520
Length without forks	mm L2	350	350	350	350	350
Chassis width	mm B	790	790	790	790	790
Wheel base	mm y	980	980	980	980	980
Fork dimensions	mm	165 x 60	165 x 60	165 x 60	165 x 60	165 x 60
Fork length	mm L1	1170	1170	1170	1170	1170
Fork width	mm b	540	540	540	540	540
Ground clearance	mm ml	0 - 30	0 - 30	0 - 30	0 - 30	0 - 30
Working aisle AST3	mm	1810	1810	1810	1810	1810
Turning radius	mm Wa	1090	1090	1090	1090	1090
Parking brake		Mechanical	Mechanical	Mechanical	Mechanical	Mechanical
Lifting motor	kW	0,8	0,8	0,8	0,8	0,8
Battery capacity	V / Ah	12 / 44	12 / 44	12 / 44	12 / 44	12 / 44
Charger	V / A	12 / 4	12 / 4	12 / 4	12 / 4	12 / 4

INNOLIFT Self Loader Straddle

Version 7 (60164)

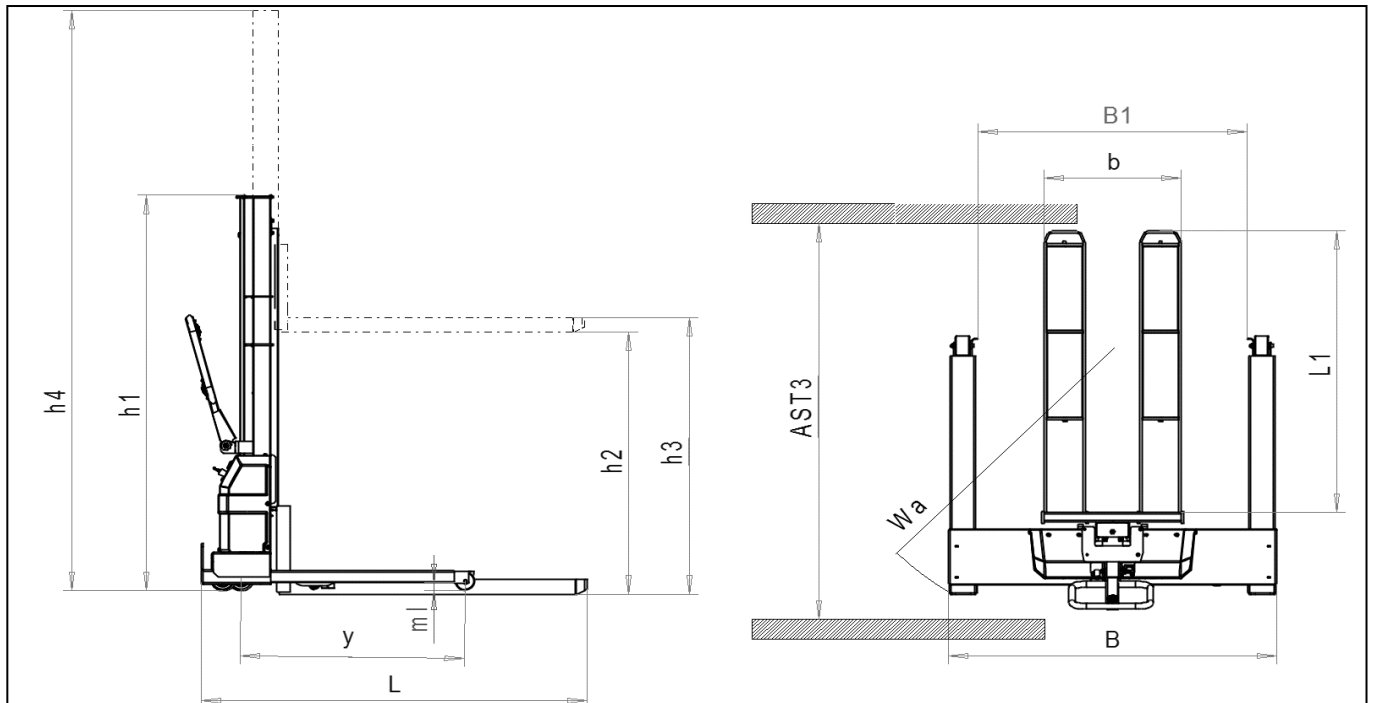

Technical Data Sheet INNOLIFT		Straddle	Straddle
		IXL550.1250.US	IXXL500.1400.US
Power		Battery	Battery
Capacity	kg	550 (1210 lbs)	500 (1100 lbs)
Load centre	mm	600 (23,6")	600 (23,6")
Lifting height	mm h3	1250 (49,2")	1400 (55,1")
Loading height	mm h2	1150 (45,2")	1300 (51,1")
Own weight	kg	262 (580 lbs)	268 (590 lbs)
Overall lowered height	mm h1	1650 (65,0")	1800 (70,86")
Overall extended height	mm h4	2790 (109,9")	3090 (121,7")
Wheel material		Polyurethane	Polyurethane
Wheel dimensions, front	mm	75 x 60	75 x 60
Wheel dimensions, rear	mm	100 x 40	100 x 40
Total length	mm L	1550	1550
Length without forks	mm L2	380	380
Width between support legs	mm B1	1050 (41,33")	1050 (41,33")
Chassis width	mm B	1290 (50,79")	1290 (50,79")
Wheel base	mm y	980	980
Fork dimensions	mm	165 x 60	165 x 60
Fork length	mm L1	1170	1170
Fork width	mm b	540	540
Ground clearance	mm ml	0 - 30	0 - 30
Working aisle AST3	mm	1890	1890
Turning radius	mm Wa	1250	1250
Parking brake		Mechanical	Mechanical
Lifting motor	kW	0,8	0,8
Battery capacity	V / Ah	12 / 44	12 / 44
Charger	V / A	12 / 10	12 / 10

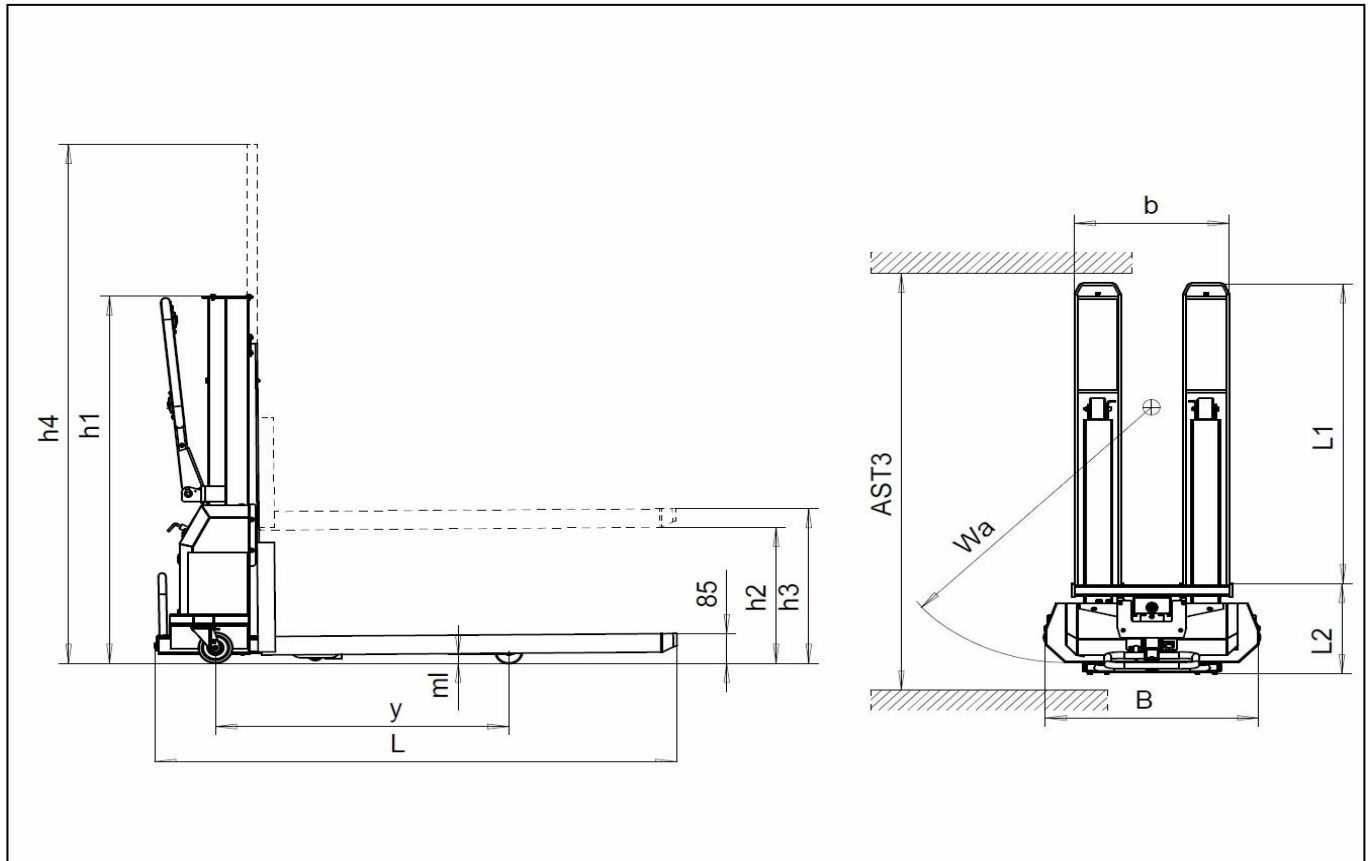

Technical Data Sheet
INNOLIFT

		IL1000.800	IL1000.1000	IXL1000.1250
Power		Battery	Battery	Battery
Capacity	kg	1000	1000	1000
Load centre	mm	600	600	600
Lifting height	mm h3	800	1000	1250
Loading height	mm h2	700	900	1150
Own weight	kg	252	257	265
Overall lowered height	mm h1	1250	1450	1710
Overall extended height	mm h4	1970	2370	2880
Wheel material		Polyurethane	Polyurethane	Polyurethane
Wheel dimensions, front	mm	80 x 54	80 x 54	80 x 54
Wheel dimensions, rear	mm	125 x 40	125 x 40	125 x 40
Total length	mm L	1570	1570	1570
Length without forks	mm L2	390	390	390
Chassis width	mm B	1000	1000	1000
Wheel base	mm y	980	980	980
Fork dimensions	mm	175 x 60	175 x 60	175 x 60
Fork length	mm L1	1175	1175	1175
Fork width	mm b	540	540	540
Ground clearance	mm ml	0 - 30	0 - 30	0 - 30
Working aisle AST3	mm	1860	1860	1860
Turning radius	mm Wa	1140	1140	1140
Parking brake		Mechanical	Mechanical	Mechanical
Lifting motor	kW	0,8	0,8	0,8
Battery capacity	V / Ah	12 / 44	12 / 44	12 / 44
Charger	V / A	12 / 10	12 / 10	12 / 10

INNOLIFT Self Loader - **E-Drive**

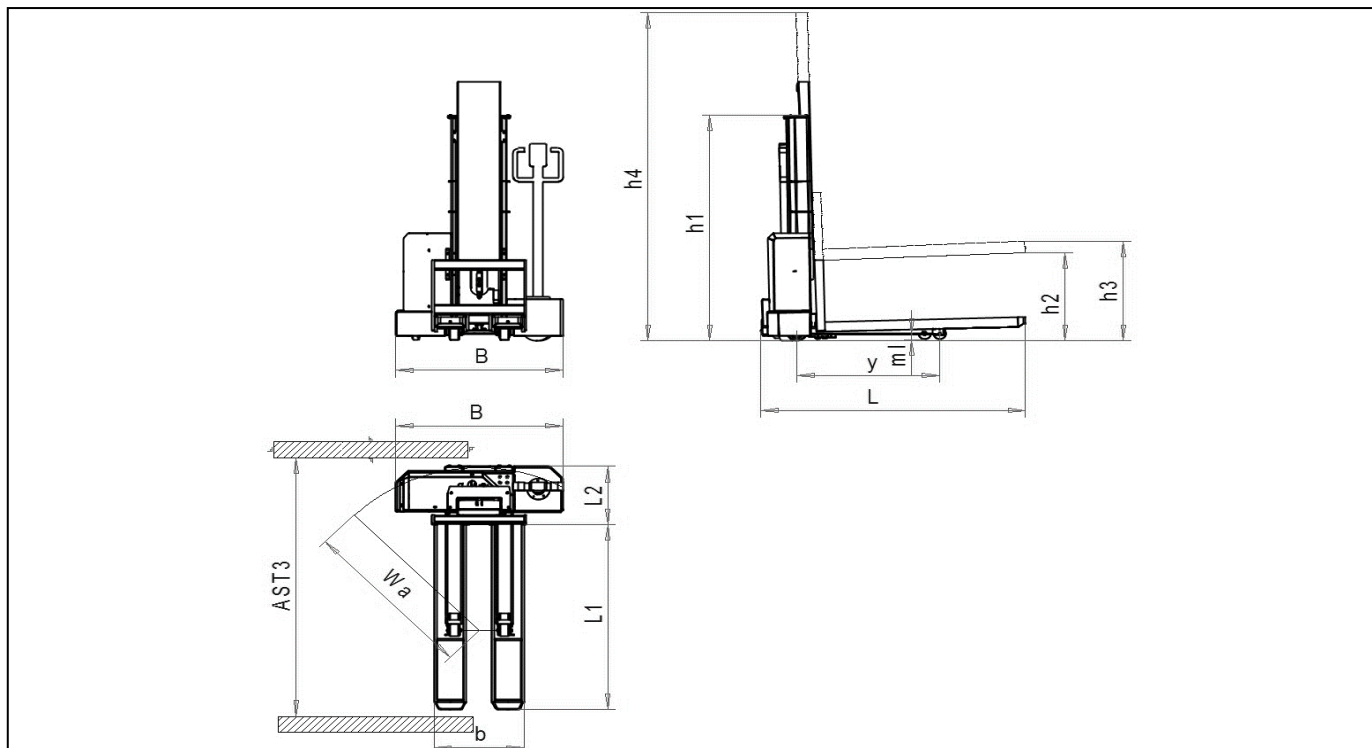

Technical Data Sheet INNOLIFT

		EL1000.1000	EXL1000.1250
Power		Electric	Electric
Capacity	kg (lb)	1000 (2200 lb)	1000 (2200 lb)
Load centre	mm (inch)	600 (23,62")	600 (23,62")
Lifting height	mm h3 (inch)	1000 (39,37")	1250 (49,21")
Loading height	mm h2 (inch)	900 (35,43")	1150 (45,27")
Own weight	kg (lb)	320 (705 lb)	330 (728 lb)
Overall lowered height	mm h1 (inch)	1470 (57,87")	1720 (67,71")
Overall extended height	mm h4 (inch)	2390 (94,1")	2890 (113,77")
Wheel material		Polyurethane	Polyurethane
Wheel dimensions, front	mm (inch)	75 x 60	75 x 60
Wheel dimensions, rear	mm (inch)	100 x 40 (3,95" x 1,57")	100 x 40 (3,95" x 1,57")
Wheel dimensions, Drivemotor	mm (inch)	210 x 80 (8,27" x 3,15")	210 x 80 (8,27" x 3,15")
Total length	mm L (inch)	1595 (62,8")	1595 (62,8")
Length without forks	mm L2 (inch)	390 (15,35")	390 (15,35")
Chassis width	mm B (inch)	1000 (39,37")	1000 (39,37")
Wheel base	mm y (inch)	980 (38,58")	980 (38,58")
Fork dimensions	mm (inch)	195 x 60 (7,68" x 2,36")	195 x 60 (7,68" x 2,36")
Fork length	mm L1 (inch)	1200 (47,24")	1200 (47,24")
Fork width	mm b (inch)	540 (21,26")	540 (21,26")
Ground clearance	mm ml	0 - 30	0 - 30
Working aisle AST3	mm (inch)	1860 (53,15")	1860 (53,15")
Turning radius	mm Wa (inch)	1140 (44,88")	1140 (44,88")
Parking brake		Electric	Electric
Lifting motor	kW	0,8	0,8
Driving motor	kW	0,65	0,65
Color, Chassis / Cover		Black / Green	Black / Green
Battery capacity	V / Ah	24 / 38	24 / 38
Charger	V / A	24 / 10	24 / 10

*This is for general reference only. Specific fit depends on vehicle make, model & year and any vehicle adjustments or customizations.

IMPORTANT: The Adjustable Rear Plate accessory for cargo van's with step bumpers is required for safe 90 degree loading/unloading to avoid potential injury